

iQntrol-S2, iQntrol-S1, SC01, SC02, SC04

Технические характеристики

По вопросам продаж и поддержки обращайтесь:

Алматы (7273)495-231	Казань (843)206-01-48	Новокузнецк (3843)20-46-81	Смоленск (4812)29-41-54
Архангельск (8182)63-90-72	Калининград (4012)72-03-81	Новосибирск (383)227-86-73	Сочи (862)225-72-31
Астрахань (8512)99-46-04	Калуга (4842)92-23-67	Омск (3812)21-46-40	Ставрополь (8652)20-65-13
Барнаул (3852)73-04-60	Кемерово (3842)65-04-62	Орел (4862)44-53-42	Сургут (3462)77-98-35
Белгород (4722)40-23-64	Киров (8332)68-02-04	Оренбург (3532)37-68-04	Тверь (4822)63-31-35
Брянск (4832)59-03-52	Краснодар (861)203-40-90	Пенза (8412)22-31-16	Томск (3822)98-41-53
Владивосток (423)249-28-31	Красноярск (391)204-63-61	Пермь (342)205-81-47	Тула (4872)74-02-29
Волгоград (844)278-03-48	Курск (4712)77-13-04	Ростов-на-Дону (863)308-18-15	Тюмень (3452)66-21-18
Вологда (8172)26-41-59	Липецк (4742)52-20-81	Рязань (4912)46-61-64	Ульяновск (8422)24-23-59
Воронеж (473)204-51-73	Магнитогорск (3519)55-03-13	Самара (846)206-03-16	Уфа (347)229-48-12
Екатеринбург (343)384-55-89	Москва (495)268-04-70	Санкт-Петербург (812)309-46-40	Хабаровск (4212)92-98-04
Иваново (4932)77-34-06	Мурманск (8152)59-64-93	Саратов (845)249-38-78	Челябинск (351)202-03-61
Ижевск (3412)26-03-58	Набережные Челны (8552)20-53-41	Севастополь (8692)22-31-93	Череповец (8202)49-02-64
Иркутск (395)279-98-46	Нижний Новгород (831)429-08-12	Симферополь (3652)67-13-56	Ярославль (4852)69-52-93
Россия (495)268-04-70	Киргизия (996)312-96-26-47	Казахстан (7172)727-132	



**PLUG-IN
READY**

Solar control SC01 with 2-way ball valve

consisting of a ready to plug-in compact control unit, the required pool temperature can be set manually (+20 °C up to +40 Grad °C).

TECHNICAL DATA

- Cold water sensor with 3 m cable
- Warm water sensor with 10 m cable
- Original Praher® 2-way PVC ball valve with EO510 electric actuator
- IND 12-24 V AC/DC (DN40/d50 or DN50/d63)
- Manual override
- IP54 protection code
- CE-marking
- Optical position indication

DIMENSIONS

d	DN	G	A	D	E	H	t	Z	PN
mm	mm	Zoll	mm	mm	mm	mm	mm	mm	bar
40	32	1 ¼"	77	101,5	135	155	26,5	87	16
50	40	1 ½"	77	101,5	135	155	31,5	87	16
63	50	2"	87	115,3	142	163	38,5	99	16

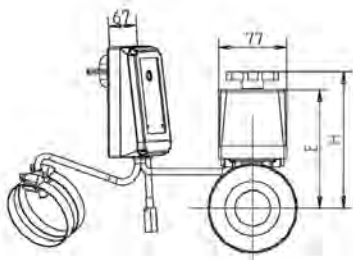
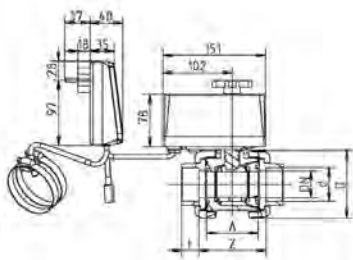

Product	G-kg	PU	Prod.No.
Solar set SC01 mit 2-way ball valve S6 DN40 PVC PVCu solvent socket ends d50 metric PN3 EPDM PTFE EO510 24V IND	2.83	1.00	129635
Solar set SC01 mit 2-way ball valve S6 DN50 PVC PVCu solvent socket ends d63 metric PN3 EPDM PTFE EO510 24V IND	3.11	1.00	129636

INSTALLATION SCHEME

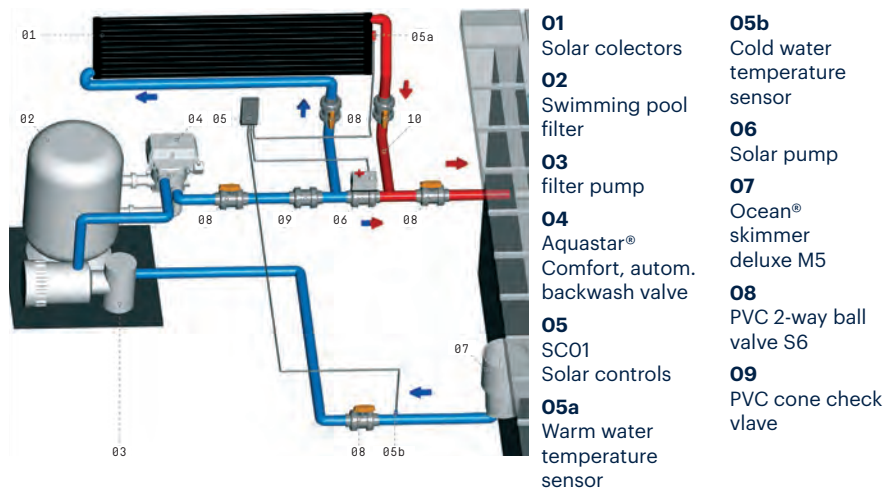



PLUG-IN
READY

Solar control SC01 with 3-way ball valve

consisting of a ready to plug-in compact control unit, the required pool temperature can be set manually (+20 °C up to +40 Grad °C).

TECHNICAL DATA

- Cold water sensor with 3 m cable
- Warm water sensor with 10 m cable
- Original Praher® 2-way PVC ball valve with EO510 electric actuator
- IND 12-24 V AC/DC (DN40/d50 or DN50/d63)
- Integrated pressure hole in the ball
- Manual override
- IP54 protection code
- CE-marking
- Optical position indication

DIMENSIONS

d	DN	G	A	C	D	E	H	L	Y	t	Z	PN
mm	mm	Zoll	mm	mm	mm	mm	mm	mm	mm	mm	mm	bar
40	32	1 1/4"	162	81	101	200	220	56	84,5	27,5	169	16
50	40	1 1/2"	162	81	101	200	220	56	85,5	31,5	171	16
63	50	2"	181	90,5	121,5	216	236	64	96,5	38,5	193	16

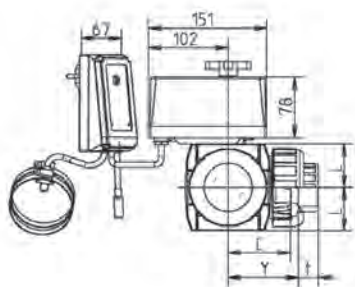
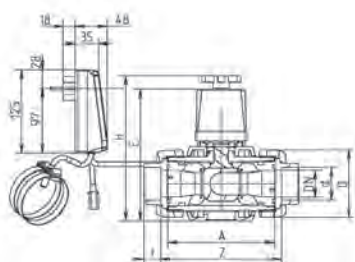

Product	G-kg	PU	Prod.No.
Solar set SC01 with 3-way ball valve s4 DN40 PVC PVCu solvent socket ends d50 metric PN3 EPDM tpe EO510 24V IND solar	4.09	1.00	129637
Solar set SC01 with 3-way ball valve s4 DN50 PVC PVCu solvent socket ends d63 metric PN3 EPDM tpe EO510 24V IND solar	5.10	1.00	129638

INSTALLATION SCHEME

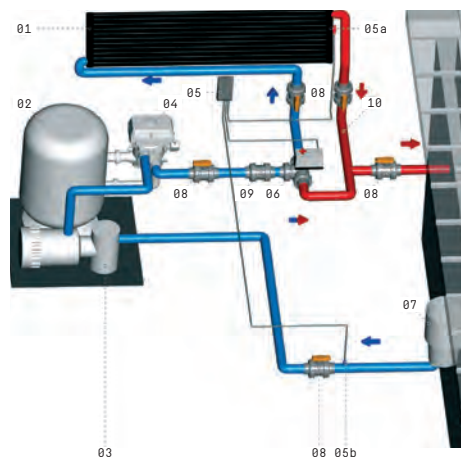

- 01** Solar collectors
- 02** Swimming pool filter
- 03** filter pump
- 04** Aquastar Comfort, autom. backwash valve
- 05** SC01 Solar control
- 05a** Warm water temperature sensor
- 05b** Cold water temperature sensor
- 06** Ocean skimmer deluxe M5
- 07** PVC 2-way ball valve S6
- 08** PVC cone check valve
- 09** Energy PVC pipes and fittings
- 10** power supply, socket



PLUG-IN
READY

Solar control SC02

The SC02 consists of a ready to plug-in and compact (acc. to DIN) control box, the required pool temperature (+5°C up to +60°C) can be set manually. Furthermore this control system has an integrated connection for the “solar pump” 230V for direct control, digital display, cooling function as control function that in case of increasing pool water temperature set-up temperature is not exceeded (“red blinking leds”), adjustment of temperature difference between pool and collector from +2°C up to 20°C, switch from Celsius to Fahrenheit possible. Furthermore there are included a cold water temperature sensor with 3 m connection cable as well as a warm water temperature sensor with 10 m connection cable which have to be fixed after the skimmer or the solar absorber. The SC02 solar controls are mainly used for solar heatings in private pools. This provides a substantial extension of the outdoor pool season.

Product	G-kg	PU	Prod.No.
Solar-Control SC02 230VAC	1.45	1.00	120848

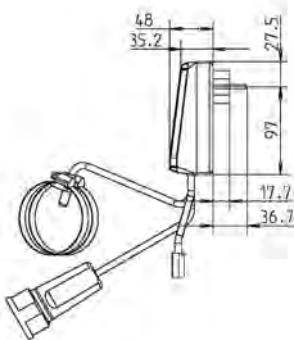
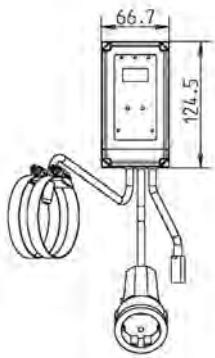

INSTALLATION SCHEME

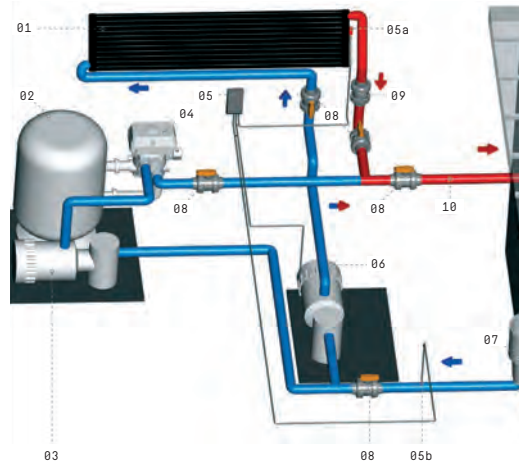

- 01** Solar collectors
- 02** Swimming pool filter
- 03** filter pump
- 04** Aquastar® Comfort, autom. backwash valve
- 05** SC01 Solar controls
- 05a** Warm water temperature sensor
- 05b** Cold water temperature sensor
- 06** Solar pump
- 07** Ocean® skimmer deluxe M5
- 08** PVC 2-way ball valve S6
- 09** PVC cone check valve
- 10** Energy PVC pipes and fittings



Solar control SC04 with 2- and 3-way ball valve

ECONOMICAL AND EFFICIENT 2 AND 3 WAY PVC VALVE WITH INTEGRATED SOLAR CONTROL.

The SC04 which can be easily integrated in the hose piping by using hose nozzles (optional accessories).

Another possibility is the direct installation on the Ocean V6 (installation diagram on request). With this compact solar control all necessary functions are integrated with the EO510 electric actuator. Adjustment of pool water temperature from +20°C up to +40°C is possible. Also included are: a cold water sensor with 3 m connection cable, and a warm water sensor with 10 m connection cable (each one) which can be fixed to the piping or after the skimmer respectively on the solar absorber, 2 or 3 way Praher PVC ball valves DN40/ d50 or DN50/d63 way), manual override, protection code IP54, CE marking and optical position indication.with EO510 electric actuator 230V AC/DC with integrated balance hole in the ball (3

Product	G-kg	PU	Prod.No.
Solar control SC04 mit 2-way ball valve S6 DN40 PVC grey PVCu solvent socket ends d50 metric PN3 EPDM PTFE EO510 100-240 VAC	2.43	1.00	126566A
Solar control SC04 with 3-W-T-ball DN40 PVC grey PVCu solvent socket ends d50 metric PN3 EPDM tpe EO510 100-240 VAC	3.77	1.00	126564A



SOLAR

3-way ball valve S4 SOLAR EO510 eco/ind

TECHNICAL DATA

- Optical position indication
- Manual override
- Compact construction
- Chlorine and sea water resistant (corrosion-free)
- IP 54 (EO510) protection code
- Electr. position feedback
- CE-marking
- Integrated pressure balance system (by-pass system) by a drillhole in the T-ball and pressure ring, therefore 100% tightness not guaranteed

DIMENSIONS

d	DN	G	A	C	D	E	L	H	Y	Z	t	OPR
mm	mm	Zoll	mm	mm	mm	mm	mm	mm	mm	mm	mm	max. bar
40	32	1 1/2"	162	81	101	199	220	56	84,5	169	27,5	3
50	40	1 1/2"	162	81	101	199	56	219	85,5	171	31,5	3
63	50	2"	181	90,5	121,5	215	64	235	96,5	193	38,5	3

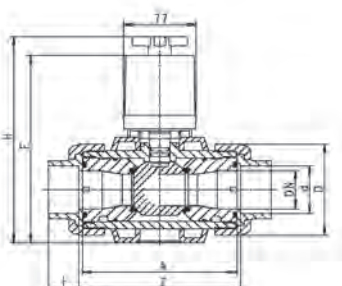
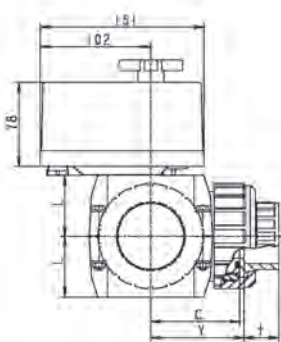

Product	G-kg	PU	Prod.No.
3-WAY BALL VALVE S4 SOLAR EO510 IND			
Ball Valve S4 3W T-ball DN32 PVC grey PVCu solvent socket ends d40 metric PN3 EPDM tpe EO510 IND 12-24V AC/DC solar	2.69	1.00	122635
Ball Valve S4 3W T-ball DN40 PVC grey PVCu solvent socket ends d50 metric PN3 EPDM tpe EO510 IND 12-24V AC/DC solar	2.72	1.00	129791A
Ball Valve S4 3W T-ball DN50 PVC grey PVCu solvent socket ends d63 metric PN3 EPDM tpe EO510 IND 12-24V AC/DC solar	3.77	1.00	122636
3-WAY BALL VALVE S4 SOLAR EO510 ECO			
Ball Valve S4 3W T-ball DN32 PVC grey PVCu solvent socket ends d40 metric PN3 EPDM tpe EO510 ECO 230VAC solar	2.72	1.00	120647
Ball Valve S4 3W T-ball DN40 PVC grey PVCu solvent socket ends d50 metric PN3 EPDM tpe EO510 ECO 230VAC solar	3.84	1.00	120651
Ball Valve S4 3W T-ball DN50 PVC grey PVCu solvent socket ends d63 metric PN3 EPDM tpe EO510 ECO 230VAC solar	3.79	1.00	120655

NEW

iQntrol-S2 solar control with large digital display

These controllers are located in a service-friendly plug housing. The mounting base with its screw terminals is mounted on the wall or snapped onto a DIN rail. Two potential-free changeover contacts enable easy control of the pump and a motor / solenoid valve. Setting ranges are 1°C to 12°C for the differential temperature and 20°C to 40°C for the maximum temperature limitation.

Product	G-kg	PU	Prod.No.
iQntrol-S2 solar control with large display with adjustment Tmax. (20-40°C), switch for on-, off-, and automatic mode, incl. 2x temp. sensors and housing for sensor ½"	0.63	1.00	7300675

NEW

iQntrol-S1 solar control with manual adjustment Tmax. (20-40°C) and Tdiff.

Product	G-kg	PU	Prod.No.
iQntrol-S1 solar control with adjustment Tmax. (20-40°C), switch for on-, off-, and automatic mode, incl. 2x temp. sensors and housing for sensor ½"	0.60	1.00	7300674

Immersion probe made of brass chromed d10mm



Product	G-kg	PU	Prod.No.
Diving detector brass d10mm with 20cm cable	0.02	1.00	7300689
Diving detector brass d10mm with 20m cable	0.41	1.00	7300690
Diving detector brass d10mm with 20m cable	0.83	1.00	7300691

Contact sensor made of brass



Product	G-kg	PU	Prod.No.
Attach sensor brass chromed with 20cm cable	0.03	1.00	7300692
Attach sensor brass chromed with 10m cable	0.41	1.00	7300693
Attach sensor brass chromed with 20m cable	0.81	1.00	7300694

Chrome plated brass housing for sensor



Product	G-kg	PU	Prod.No.
Chrome plated brass housing for sensor d10	0.08	1.00	7300695



PVC housing for sensor for aggressive medias

Product	G-kg	PU	Prod.No.
PVC housing for sensor for aggressive medias to glue inside a PVC T-pcs. for diving detector d10	0.01	1.00	7300696



Shielded and twisted sensor cable for Peraqua temperature sensor 100m

Product	G-kg	PU	Prod.No.
Shielded and twisted sensor cable for Peraqua temperature sensor 100m	3.94	1.00	7300697



Power supply for 12V or 24V PVC motor valves

Product	G-kg	PU	Prod.No.
Power Supply for 12V or 24V PVC ball valves for heating – and solar control units (not vor solenoid valves)	0.03	1.00	7300703

По вопросам продаж и поддержки обращайтесь:

Алматы (7273)495-231	Казань (843)206-01-48	Новокузнецк (3843)20-46-81	Смоленск (4812)29-41-54
Архангельск (8182)63-90-72	Калининград (4012)72-03-81	Новосибирск (383)227-86-73	Сочи (862)225-72-31
Астрахань (8512)99-46-04	Калуга (4842)92-23-67	Омск (3812)21-46-40	Ставрополь (8652)20-65-13
Барнаул (3852)73-04-60	Кемерово (3842)65-04-62	Орел (4862)44-53-42	Сургут (3462)77-98-35
Белгород (4722)40-23-64	Киров (8332)68-02-04	Оренбург (3532)37-68-04	Тверь (4822)63-31-35
Брянск (4832)59-03-52	Краснодар (861)203-40-90	Пенза (8412)22-31-16	Томск (3822)98-41-53
Владивосток (423)249-28-31	Красноярск (391)204-63-61	Пермь (342)205-81-47	Тула (4872)74-02-29
Волгоград (844)278-03-48	Курск (4712)77-13-04	Ростов-на-Дону (863)308-18-15	Тюмень (3452)66-21-18
Вологда (8172)26-41-59	Липецк (4742)52-20-81	Рязань (4912)46-61-64	Ульяновск (8422)24-23-59
Воронеж (473)204-51-73	Магнитогорск (3519)55-03-13	Самара (846)206-03-16	Уфа (347)229-48-12
Екатеринбург (343)384-55-89	Москва (495)268-04-70	Санкт-Петербург (812)309-46-40	Хабаровск (4212)92-98-04
Иваново (4932)77-34-06	Мурманск (8152)59-64-93	Саратов (845)249-38-78	Челябинск (351)202-03-61
Ижевск (3412)26-03-58	Набережные Челны (8552)20-53-41	Севастополь (8692)22-31-93	Череповец (8202)49-02-64
Иркутск (395)279-98-46	Нижний Новгород (831)429-08-12	Симферополь (3652)67-13-56	Ярославль (4852)69-52-93
Россия (495)268-04-70	Киргизия (996)312-96-26-47	Казахстан (7172)727-132	